

Specifications

Current Rating: 0.8A~1A AC,DC(Per Pin)

Voltage Rating: 1400V AC,DC(Per Pin)

Temperature Range: -25°C ~ +85°C

Contact Resistance: 10mΩ Max.

Insulation Resistance: 1000MΩ Min.

Withstanding Voltage: 3800V AC/minute

Assembly Layout

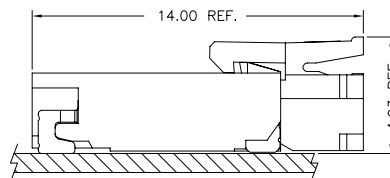

Ordering Code

① ② ③ ④
A3502 X X-XP

- ① Series No.
- ② Housing Type: H=Housing
- ③ Blank=Receptacle, M=Plug ,MA= Plug A Type
- ④ No. of Circuits

① ② ③ ④
A3502 XX-X-XP

- ① Series No.
- ② Connector Type: WR=Right Angle
- ③ Mounting Type: S=SMT
- ④ No. of Circuits



A3502 SERIES

3.50mm Pitch Wire to Board and Wire to Wire Connector

A3502H-02P

3.50mm Pitch Housing

Reference Information:

*Material: Thermoplastic

*Suitable A3501 Series Terminal

*Mates with A3502HM Series Housing and A3501 Series Wafer

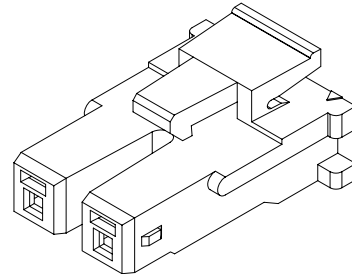
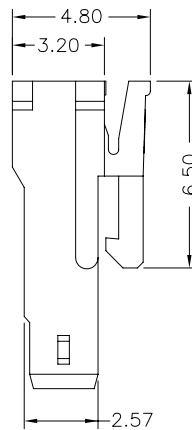
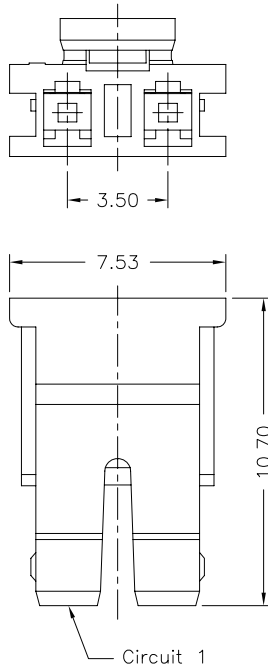

A3502H-XP	X	X	X	XX	X	XX	X
	①	②	③	④	⑤	⑥	⑦
①	Halogen Free or Not						
②	Material						
③	Color						
④	Plating Code for Contacts						
⑤	Plating Code						
⑥	Option Code						
⑦	Packing Code						

A3502HM-02P

3.50mm Pitch Housing

Reference Information:

*Material: Thermoplastic

*Suitable A3501M Series Terminal

*Mates with A3502H Series Housing

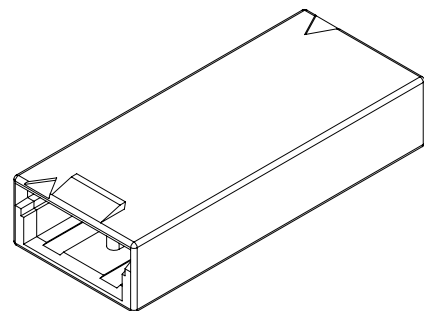
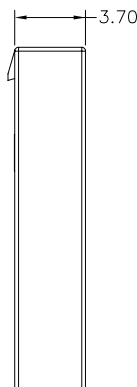
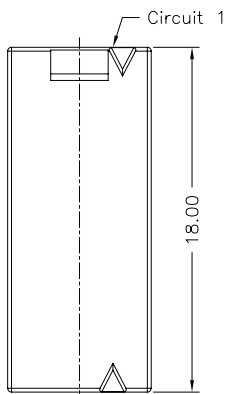
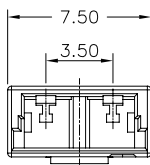

A3502HM-XP	X	X	X	XX	X	XX	X
	①	②	③	④	⑤	⑥	⑦
①	Halogen Free or Not						
②	Material						
③	Color						
④	Plating Code for Contacts						
⑤	Plating Code						
⑥	Option Code						
⑦	Packing Code						

A
B
C
F

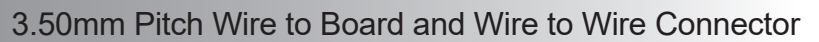

3.50mm Pitch Housing

*Mates with A3502H Series Housing

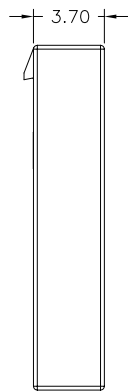
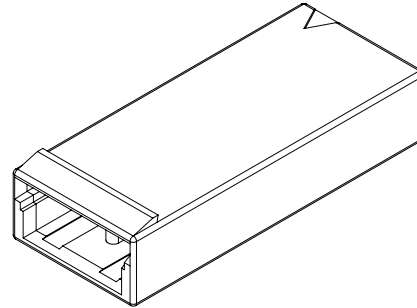

A3502HMA-XP X X X XX X XX X
 ① ② ③ ④ ⑤ ⑥ ⑦

① Halogen Free or Not
② Material
③ Color
④ Plating Code for Contacts
⑤ Plating Code
⑥ Option Code
⑦ Packing Code

-3.50mm Pitch 90° Wafer - SMT Type

*Mates with A3502H Series Housing

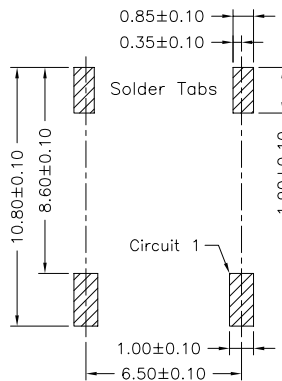
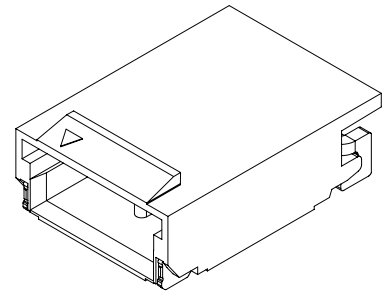

A3502WR-S-XP X X X XX X XX X

① Halogen Free or Not ① ② ③ ④ ⑤ ⑥ ⑦

② Material

③ Color

④ Plating Code for Contacts

⑤ Plating Code

⑥ Option Code

⑦ Packing Code

PCB Layout