

Specifications

Current Rating: 0.5A~1A AC,DC(Per Pin)

Voltage Rating: 50V AC,DC(Per Pin)

Temperature Range: -25°C ~ +85°C

Contact Resistance: 20mΩ Max.

Insulation Resistance: 100MΩ Min.

Withstanding Voltage: 500V AC/minute

A

B

C

F

Ordering Code

① ② ③ ④
A1007-X X X

- ① Series No.
- ② Plating Code: T=Tin-Plated, G=Gold-Plated
- ③ Material: P=Phosphor Bronze
- ④ E=Stamping Before Plating

① ② ③ ④ ⑤
A1007 X X-2X NP

- ① Series No.
- ② Housing Type: H=Housing
- ③ Blank=Without Lock Structure Type,
A=With Lock Structure Type
- ④ Blank=Single Row, 2X=Dual Row
- ⑤ No. of Circuits



A1007 SERIES

1.00mm Pitch Wire to Board Connector

A1007-XXX

1.00mm Pitch Crimp Terminal

Reference Information:

*Used in A1007 Series Housing

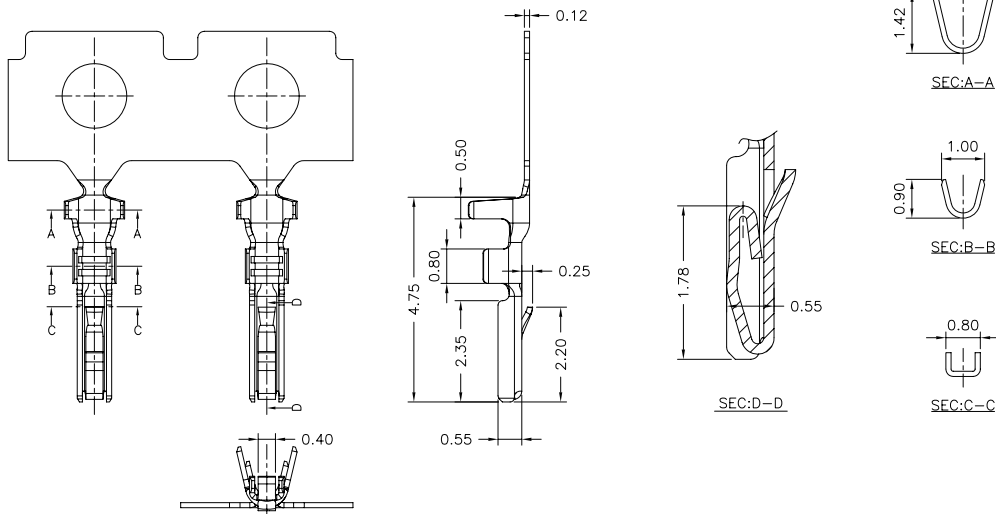

Ordering Information & Specifications:

Unit:mm

Part No.	Wire Range	Insulation O.D.	Material	Finish	Qty/Reel
A1007-TPE	AWG#28-#32	0.80mm(Max)	Phosphor Bronze	Tin-Plated	15,000Pcs
A1007-GPE	AWG#28-#32	0.80mm(Max)	Phosphor Bronze	Gold-plated	15,000Pcs

Note:E-Stamping Before Plating

A1007H

1.00mm Pitch Housing

Reference Information:

*Material: Thermoplastic

*Suitable A1007 Series Terminal

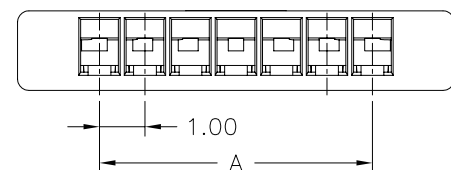

Marking by
every 5 circuit

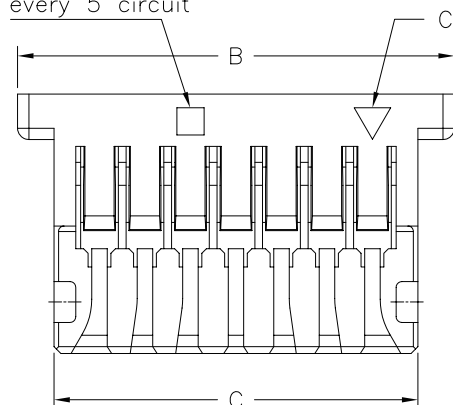

A1007H-XP	X	X	X	XX	X	XX	X
	①	②	③	④	⑤	⑥	⑦
①	Halogen Free or Not						
②	Material						
③	Color						
④	Plating Code for Contacts						
⑤	Plating Code						
⑥	Option Code						
⑦	Packing Code						

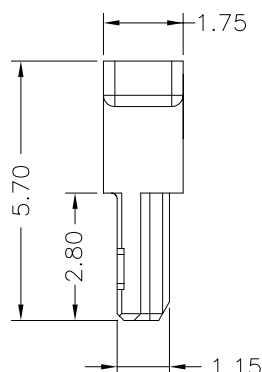
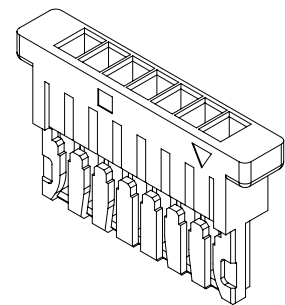

Dimensions:

Circuit No.	Dimensions		
	A	B	C
02	----	4.60	3.00
06	5.00	8.60	7.00
07	6.00	9.60	8.00
08	7.00	10.60	9.00
14	13.00	16.60	15.00
16	15.00	18.60	17.00
20	19.00	22.60	21.00
22	21.00	24.60	23.00
26	25.00	28.60	27.00
30	29.00	32.60	31.00

Unit:mm



A1007 SERIES

1.00mm Pitch Wire to Board Connector

A1007HA

1.00mm Pitch Housing with Lock

Reference Information:

*Material: Thermoplastic

*Suitable A1007 Series Terminal

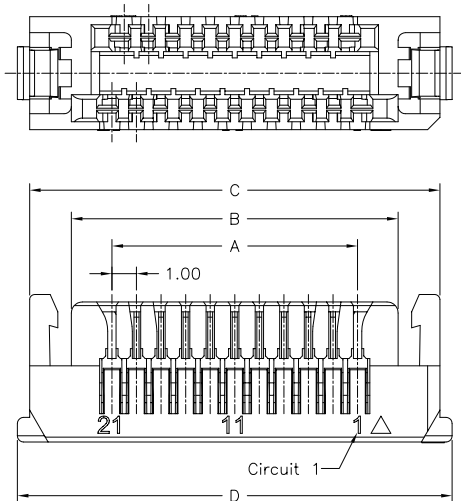

A1007 HA-XP						
	X	X	X	XX	X	XX
	①	②	③	④	⑤	⑥
⑦	Halogen Free or Not					
⑧	Material					
⑨	Color					
⑩	Plating Code for Contacts					
⑪	Plating Code					
⑫	Option Code					
⑬	Packing Code					

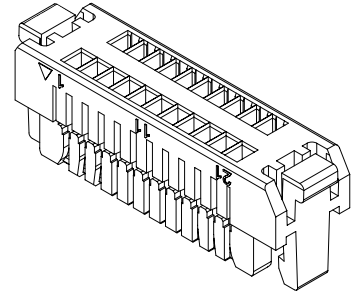

Dimensions:

Circuit No.	Dimensions			
	A	B	C	D
21	10.00	13.30	16.70	17.70
31	15.00	18.30	21.70	22.70

Unit:mm

A1007HA-2

1.00mm Pitch Dual Row Housing with Lock

Reference Information:

*Material: Thermoplastic

*Suitable A1007 Series Terminal

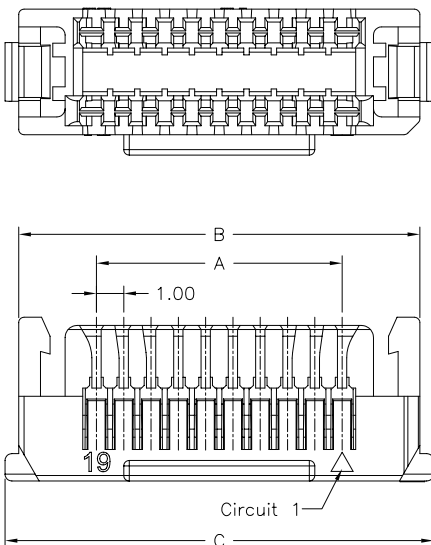

A1007 HA-2XNP						
	X	X	X	XX	X	XX
	①	②	③	④	⑤	⑥
①	Halogen Free or Not					
②	Material					
③	Color					
④	Plating Code for Contacts					
⑤	Plating Code					
⑥	Option Code					
⑦	Packing Code					

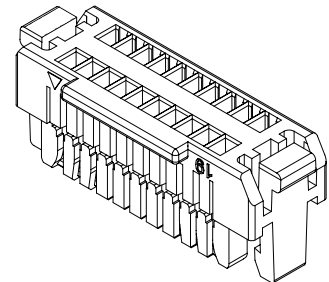

Dimensions:

Circuit No.	Dimensions		
	A	B	C
2X10	9.00	14.70	15.70
2X15	14.00	19.70	20.70
2X20	19.00	24.70	25.70
2X25	24.00	29.70	30.70

Unit:mm